

# GRASP® PERSPECTIVE - ACCESS TO ALL COMPONENTS

## LEGEND

### GRASP® Inventory

- ◆ Alpine Garden
- Amphitheater
- Ballfield
- Basketball
- ◆ Disk Golf
- ◆ Driving Range
- Fitness Path
- ◇ Golf
- ◆ Interpretive Path
- Multipurpose Field
- ◆ Natural Area
- ▲ Off Leash Area
- Open Turf
- Open Water
- Passive Area
- Picnic Area
- Play Pad
- Playground
- ▲ Public Art
- Shelter
- Structure
- Tennis
- Volleyball - Sand
- Whitewater Park

### Recreation Lands & Facilities GRASP® Perspective - Access To All Components

- Park
  - Golf Course
  - Indoor Facility
  - Unclassified Park Land
  - Public School
  - Private School
  - ◆ Trailheads - USFS
  - Trail Network
- Low GRASP Value = 8.40
- High GRASP Score = 560.80

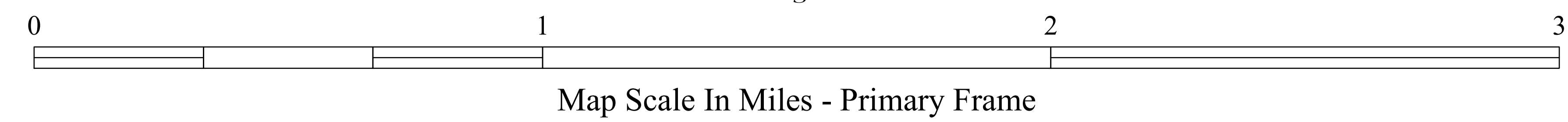

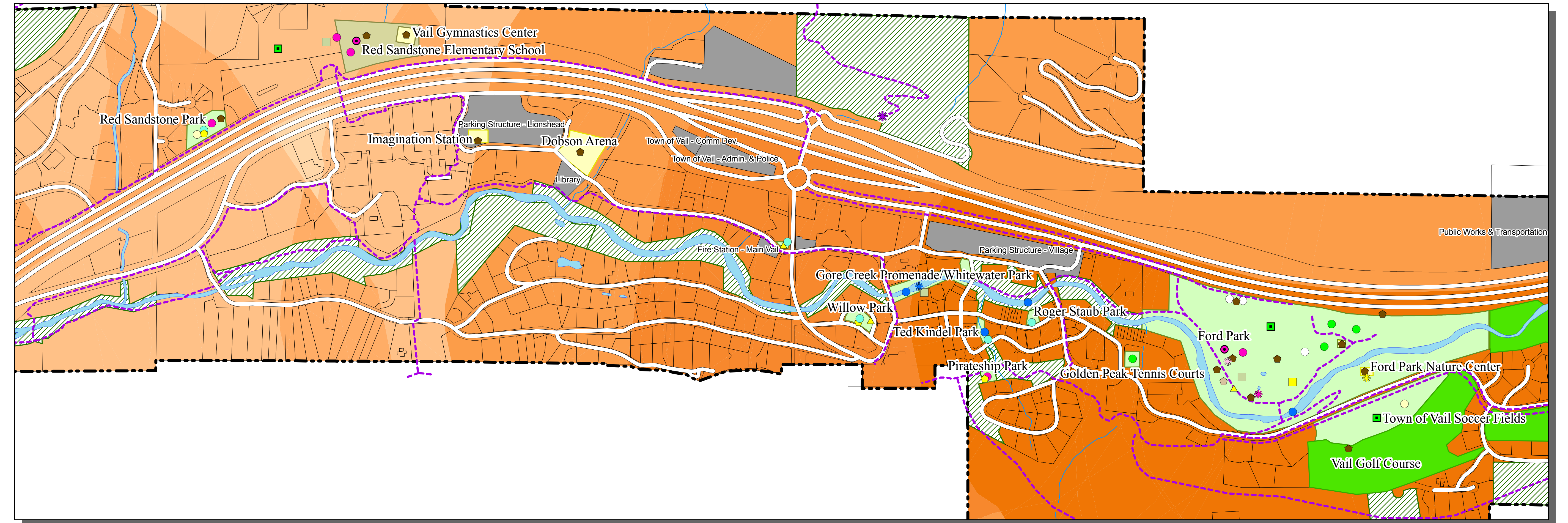

Map Produced For Town Of Vail & Vail Recreation District - Eagle County, Colorado - By The GRASP® Team  
 This Map Is Intended For Planning & Discussion Purposes Only - Please Refer To The Project Document For Map Details  
 Legend Elements May Vary In Size From Those Shown On Map  
 GIS Data Sources May Include: Eagle County, Town of Vail, US Census, ESRI, GRASP® Team  
 Copyright© 2007 Town Of Vail & Vail Recreation District - Map Revised - February 2007